

8 Piano di Recupero VIGENTE  
Opere di urbanizzazione da non eseguire

Committente \_\_\_\_\_

Progettista D.L. \_\_\_\_\_

Impresa \_\_\_\_\_





Signor CRISPI ANGELO MARIO  
via Piave n°21 -Viganò-

PIANO DI RECUPERO FABBRICATO ESISTENTE IN OSSOLA DI MISSAGLIA.  
-REALIZZAZIONE AREA A PARCHEGGIO-

Data : 27/01/2005 Tav. 1 Rapp. 1:100

Arch. PULICI CRISTINA E. via Lavandaia n°27 Missaglia tel. 039.9241296

**SEZIONE TIPO AREA A PARCHEGGIO**  
Rapp. 1:50

-  TAPPETO DI USURA IN CONGLOMERATO BITUMOSO spess. cm.2,5
-  FONDAZIONE IN CONGLOMERATO BITUMOSO (TOUT VENANT BITUMATO) spess. cm.10
-  SOTTOFONDO DI MISTO INERTE A GRANULOMETRIA STABILIZZATA spess. cm.40
-  SOTTOFONDO IN CALCESTRUZZO PER POSA CORDOLO spess. cm.10
-  CORDOLO IN CONGLOMERATO VIBROCOMPRESSO dim. cm.12/15x25

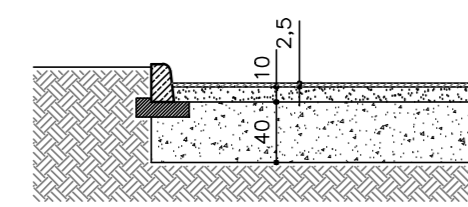

**PLANIMETRIA**

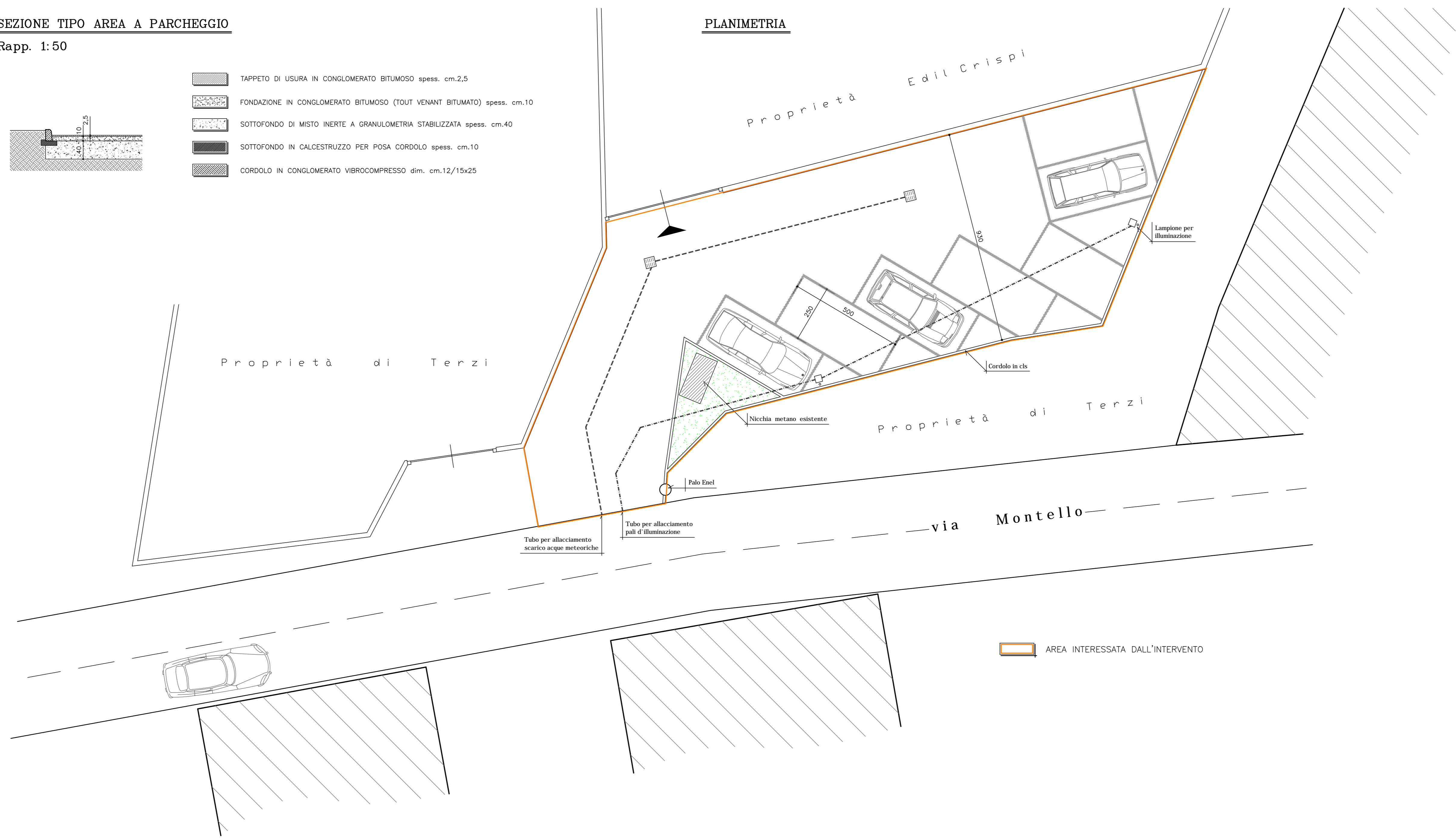

 AREA INTERESSATA DALL'INTERVENTO